

PYD
ELECTROBOMBAS

SERIE

TIGER INOX

MODELOS 75-100

DE ACHIQUE

SUBMERSIBLE SEWAGE PUMP

POMPE DE RELEVAGE POUR EAUX USÉES



CATÁLOGO TÉCNICO

TECHNICAL CATALOGUE

CATALOGUE TECHNIQUE

1. DESCRIPCIÓN DESCRIPTION DESCRIPTION

Bombas sumergibles para aguas residuales en acero inoxidable para bombear agua sucia, con sólidos en suspensión. Adecuada también para el vaciado de pozos negros, procesamiento de aguas residuales, industriales y sanitarias, etc. Los modelos monofásicos incluyen un interruptor de boya.

✳ Submersible pumps for stainless steel wastewater to pump dirty water, with suspended solids. Also suitable for draining septic tanks, processing industrial and sanitary wastewater, etc. The single-phase models include a float switch.

🇫🇷 Pompes submersibles en acier inoxydable pour eaux usées pour pomper de l'eau sale, avec des solides en suspension. Convient également pour la vidange de fosses septiques, le traitement des eaux usées industrielles et sanitaires, etc. Les modèles monophasés incluent un interrupteur à flotteur.



MATERIALES

Cuerpo de bomba: Acero INOX 304
Soporte del motor: Acero INOX 304
Eje: Acero INOX 304
Impulsor: Acero INOX 304
Doble cierre mecánico: Carb/Sic - Sic/Sic
Incluye interruptor de nivel
Cable: 10 m

✳ MATERIALS

Pump Body: Stainless Steel 304
Motor Support: Stainless Steel 304
Shaft: Stainless Steel 304
Impeller: Stainless Steel 304
Double Mechanical Closure: Carb/Sic - Sic/Sic
Includes level switch
Cable: 10 m

🇫🇷 MATÉRIELS

Corps de pompe : Acier inoxydable 304
Support moteur : Acier inoxydable 304
Arbre : Acier inoxydable 304
Turbine : Acier inoxydable 304
Double fermeture mécanique : Carb/Sic - Sic/Sic
Inclut un interrupteur de niveau
Câble : 10 m

ÁREA DE TRABAJO

Temperatura máx. del líquido: 40°C
Grado de protección: IP68
Aislamiento clase: B
Profundidad máx. de inmersión: 5 m

✳ WORKING RANGE

Max. liquid temperature: 40°C
Degree of protection: IP68
Insulation class: B
Maximum immersion depth: 5 m

🇫🇷 PLAGUE DE TRAVAIL

Température max. du liquide: 40°C
Degré de protection: IP68
Isolation class: B
Profondeur maximale d'immersion : 5 m

2. CURVAS CURVES COURBES

50 Hz n= 2890 min

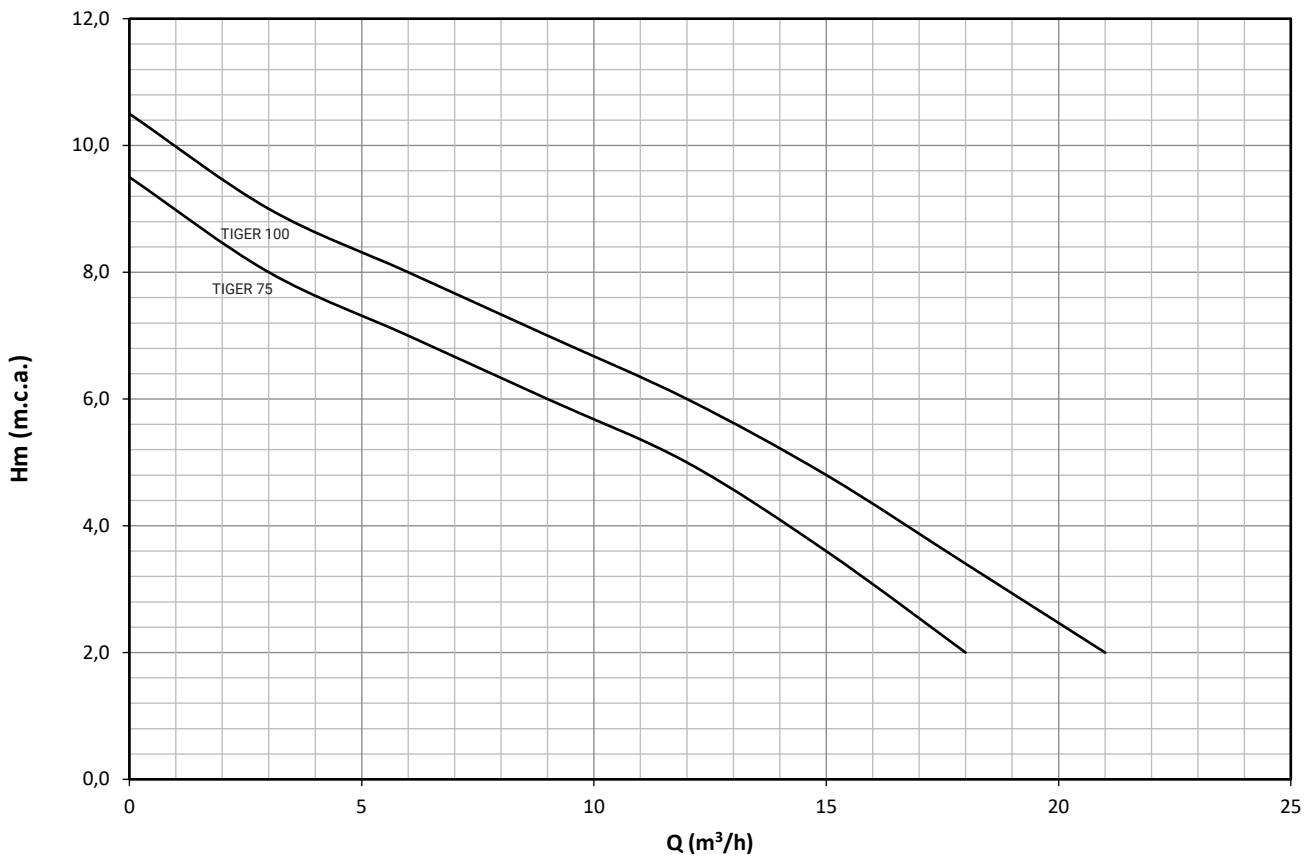

| MODELO MODEL MODÈLE | P ₂ | | DN | SÓLIDOS | INT. (A) | | COND. | PESO | CAUDAL FLOW DÉBIT | | | | | | | | | | | | | | | | | | | | | | | | | | | | | | |
|---------------------------|----------------|------|--------------------------|---------|----------|---------------------------------|-------|------|--|---|----|-----|-----|-----|-----|-----|---------------------------|--|--|--------------------------|--|--|---------------------------------|--|-----|---|---|-----|---|-----|---|------|---|---|---|---|---|-----|---|
| | kW | Hp | Ø" | mm | 220V | 380V | µF | Kg | m³/h | 0 | 3 | 6 | 9 | 12 | 15 | 18 | 21 | | | | | | | | | | | | | | | | | | | | | | |
| TIGER 75 INOX | 0,55 | 0,75 | 1 ^{1/2} | 38 | 4,0 | 1,5 | 16 | 14,0 | l/min | 0 | 50 | 100 | 150 | 200 | 250 | 300 | 350 | | | | | | | | | | | | | | | | | | | | | | |
| TIGER 100 INOX | 0,75 | 1,00 | 1 ^{1/2} | 38 | 5,2 | 1,7 | 25 | 15,0 | <table border="1"> <thead> <tr> <th colspan="3">ALTURA DE CARGA EN METROS</th> <th colspan="3">LOADING HEIGHT IN METRES</th> <th colspan="2">HAUTEUR DE CHARGEMENT EN MÈTRES</th> </tr> <tr> <th>9,5</th> <th>8</th> <th>7</th> <th>6,2</th> <th>5</th> <th>3,8</th> <th>2</th> </tr> </thead> <tbody> <tr> <td>10,5</td> <td>9</td> <td>8</td> <td>7</td> <td>6</td> <td>5</td> <td>3,4</td> <td>2</td> </tr> </tbody> </table> | | | | | | | | ALTURA DE CARGA EN METROS | | | LOADING HEIGHT IN METRES | | | HAUTEUR DE CHARGEMENT EN MÈTRES | | 9,5 | 8 | 7 | 6,2 | 5 | 3,8 | 2 | 10,5 | 9 | 8 | 7 | 6 | 5 | 3,4 | 2 |
| ALTURA DE CARGA EN METROS | | | LOADING HEIGHT IN METRES | | | HAUTEUR DE CHARGEMENT EN MÈTRES | | | | | | | | | | | | | | | | | | | | | | | | | | | | | | | | | |
| 9,5 | 8 | 7 | 6,2 | 5 | 3,8 | 2 | | | | | | | | | | | | | | | | | | | | | | | | | | | | | | | | | |
| 10,5 | 9 | 8 | 7 | 6 | 5 | 3,4 | 2 | | | | | | | | | | | | | | | | | | | | | | | | | | | | | | | | |

3. MEDIDAS MEASURES MESURES

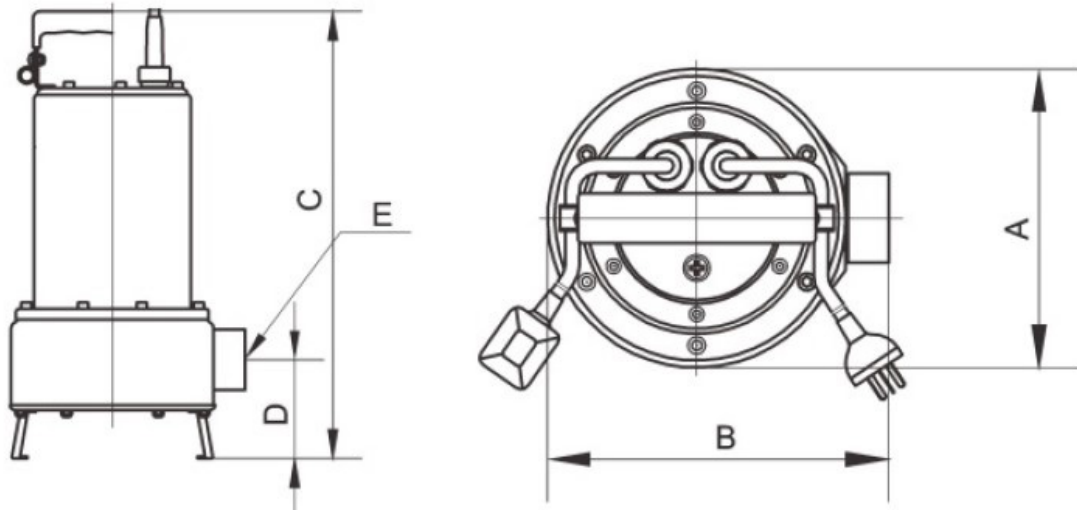

| MODELO MODEL MODÈLE | A | B | C | D | E | KG | PACK. DIM |
|---------------------------|-----|-----|-----|----|----------|----|-------------|
| TIGER 75 INOX | 170 | 195 | 370 | 76 | G 1.5" F | 14 | 180x240x390 |
| TIGER 100 INOX | 170 | 195 | 395 | 76 | G 1.5" F | 15 | 180X240X420 |

Proindecsa

C/ Paraguay, parc. 13-5/6
Polígono industrial Oeste
30820 Alcantarilla, Murcia (Spain)

Tel. : +34 968 880 852
proindecsa@proindecsa.com

www.proindecsa.com



🇪🇸 Proindecsa S.L. no se hace responsable de los posibles errores u omisiones que pueda contener este catálogo, ni de los daños o perjuicios que puedan derivarse de su uso. Proindecsa S.L. se reserva el derecho de modificar o actualizar el contenido de este catálogo en cualquier momento y sin previo aviso.

✳️ Proindecsa S.L. shall not be liable for any errors or omissions that this catalogue may contain, nor for any damages that may arise from its use. Proindecsa S.L. reserves the right to modify or update the contents of this catalogue at any time and without prior notice.

